

## ALU Comfort

# THE BASIC FOR STANDARD DOOR CONSTRUCTIONS.

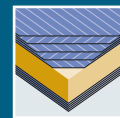

New  
decors and  
sizes



5-ply faces



MDF faces

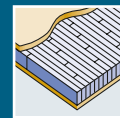

Laminated  
core

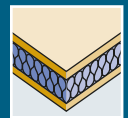

PU hard  
foam core

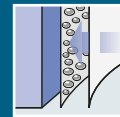

ALU moisture  
barrier



# TECHNICAL DETAILS

1/8 DOOR FRAME			
<b>1 Framing/timber</b>	Pine or red-wood timber framing finger-jointed and laminated. Further wood type frames on request.		
<b>8 Stabilizer</b>	LVL-stabilizer to absorb bending forces.		
<b>Frame width/ Minimal length/Glass apertures</b>	Thickness of door blank 68/78 mm		
	Frame width in mm	can be trimmed by	
	Top	160	100*
	Side	160	100*
Bottom	320	250	
Minimum distance for glass apertures is 200 mm on all four sides. The door width corresponds to the shortening dimension. When cut to minimum length at the bottom (250 mm), a single rebate (max. 18 mm) or fitting of dropdown seal is possible.			
2 INNER LAYER			
<b>Construction</b>	Quality-proven with long-term experience - Sandwich construction of laminated core (spruce) and HCFC-free and environmentally compatible PU hard foam - Surface stability through vertically aligned annual rings		
<b>Bonding</b>	Free of formaldehyde		
3-7 COVER BOARD			
<b>Bonding</b>	AW bonding according to DIN 68705 -2 temperature resistant up to 130° - 5 layers (noble veneer, longitudinal) Full-surface bonding with the overall construction		
EXTERNAL DOOR BLANK			
<b>Model/Finish</b>	Cut and sanded		

\* depends on rebate system and lock body

## CERTIFICATION

<b>LENGTH IN MM</b>	2,150/2,240
<b>WIDTH IN MM</b>	950/1,050/1,150
<b>THICKNESS IN MM</b>	68/78
DIFFERENT CLIMATE TESTING	
DIN EN 1121 : 2000-09	test climate „c“
DIN EN 1121 : 2000-09	test climate „d“
DIN EN 1121 : 2000-09	test climate „e“
TOLERANCE CLASSES (by using three hinges)	
DIN EN 12219 : 2000-6	3*/3
THERMAL TRANSFER COEFFICIENT	
U-value (W/m²K) DIN EN ISO 10077-2 : 2012-06	1.03**/0.95**
SOUND INSULATION	
DIN EN ISO 717-1 R <sub>w</sub> , (dB)	30
<b>WEIGHT: 2,240 X 1,050 MM KG/PIECE</b>	70/78

\* classified up to 2,260 mm height on lock side

\*\* when cut to minimal length, the U-value improves to 0.85/0.8 W/m²K



## PRODUCT RANGE

ALU COMFORT – 68 MM / 78 MM					
Length in mm	2,150 (1,800*)		2,240 (1,890*)		
Width in mm	950	1,050	950	1,050	1,150
Paint-grade	■	■	■	■	■
MDF Exterior	○	○	■	○	■

\* minimal dimension ■ order-based production ○ stockholding in 68 mm

All veneer surfaces = cut veneer or fine-line

## ALU Comfort

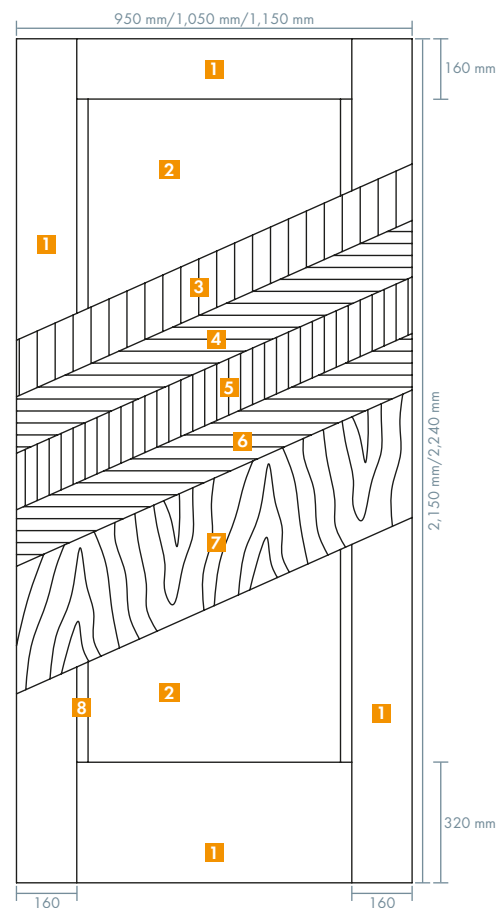

- 1** Timber framing
- 2** Inner layer core in sandwich system /PU
- 3-7** Cover board
- 8** LVL-stabilizer
- 9** PU hard foam

### Cross-section view ALU Comfort

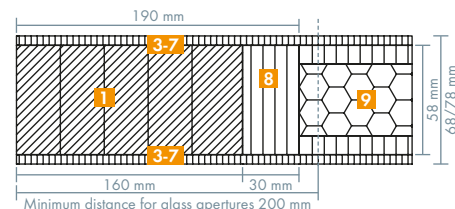

### CNC- processing service

All types may be delivered CNC processed.

Further dimensions, sizes and facings on request.



<b>Any Questions?</b> Info-Hotline: +49 8026 92538-11 <a href="http://www.moralt-ag.com">www.moralt-ag.com</a>
Moralt AG, Obere Tiefenbachstraße 1, 83734 Hausham, Phone: +49 8026 92538-0, Fax: +49 8026 92538-40, E-mail: <a href="mailto:info@moralt-ag.de">info@moralt-ag.de</a>

This information is according to the present state of knowledge and does not represent an assurance of properties. Existing laws and regulations are to be followed by the recipient of our products at his own responsibility. All information refers solely to products by Moralt AG.

Profi-Net timber distributor